

# 2ENTRY Helios

Ideal door entry system



- ★ Design of new generation
- ★ Communication over PBX / PSTN / GSM / VoIP
- ★ Calling from entrance door to your office telephones
- ★ Modular system – possibility of upgrading basic modules by camera, display, access control, biometrics etc.
- ★ Door opening with code, standard or mobile telephone or use of card



**2ENTRY Helios is a door entry system of the new generation which meets the highest demands not only for modern design, but also for high climatic resilience. This user-friendly door phone replaces conventional door systems and offers many additional features.**

2ENTRY Helios can be connected to any PBX. As a result of its modularity it enables to create customised solution according to the user's needs, not only in terms of its size, but also with various control elements and functions.

Each module can be equipped with a camera, display or card reader and an anti-vandal solution against damage.

2ENTRY Helios is made of high-quality stainless steel, and its flatness makes possible installation without cutting into the wall. The main advantages of 2ENTRY Helios door system include easy installation, above-standard functions and a modern design.



## Button telephone:



Using the keypad you can dial any number. Tone and pulse dialling is available. It is possible to restrict authorisation for calls to the public telephone network at the PBX.

## Code lock:



You can control the connected electric lock directly from the door. It is possible to define up to ten passwords with a length from 1 to 16 digits. The parameter of the period for which the switch is closed can also be set.

## Card reader:



An installed card reader offers another resource for access to your building. Up to 500 proximity cards or key fobs are available. If you connect the reader module to your PC, you can check the entries and departures of the individual card holders. If the door is forced, you will receive an alarm announcement.

## Additional switch:



This is an excellent resource for controlling a second appliance (one switch is integrated into every basic module). Closing and opening contacts are available. This switch also enables switching for an unlimited period or for the time of call duration. The additional switch can be used, for example, for switching on the light in the vestibule/corridor.

## Video:



A connected video camera makes possible visual inspection of those entering the building. The picture can be sent either to your PC or the connected LCD display or TV set. At night a good picture is ensured by switching to the black and white mode and also infrared illumination.

## Display:



The LCD display provides you with the possibility of selecting the numbers using the telephone book. Up to one thousand items are available, and you can upload them from your PC via a USB interface. Company logos or other graphics can be allocated to the individual items.

## Voice programming menu:



For simple programming, a voice menu is implemented which navigates you through the setting of the individual parameters. It is possible to hear the current parameters settings and the scope of possible values which can be saved.



# How does *2ENTRY* Helios work?

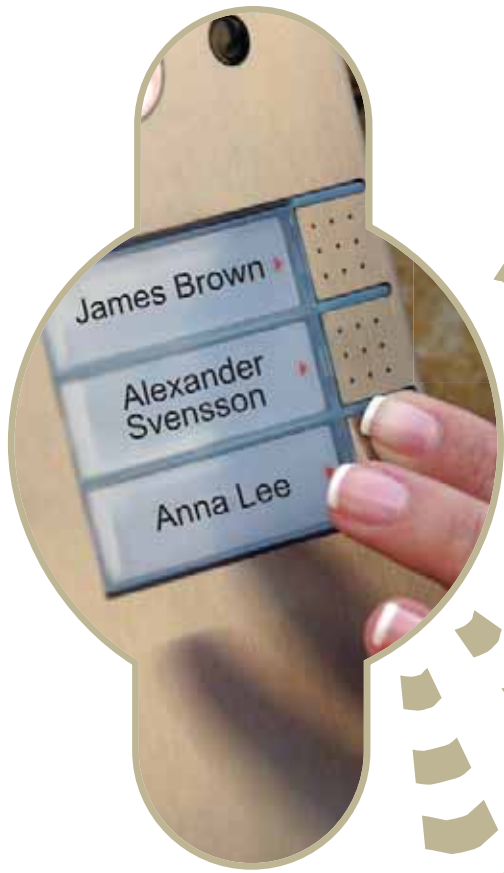

## GSM

The entry phone dials the number of the mobile telephone on which you can pick up the call and then open the door from anywhere.



## PBX

The *2ENTRY* Helios can be connected to any PBX, and each call from the door phone is routed through the PBX in the same way as a standard call from any internal line. During the call the entry doors can be opened by entering the code on a standard telephone, from which you can also call the *2ENTRY* Helios and hear what is happening outside. It is possible to define several telephone numbers on this door system which the *2ENTRY* Helios will call in sequence. If a called party is unavailable, it calls another number until the call is answered.



## PSTN

You can connect *2ENTRY* Helios directly to the public telephone network. You can pick up a call from this door phone on any standard telephone of the house or office, and you can also open the door from the same telephone.

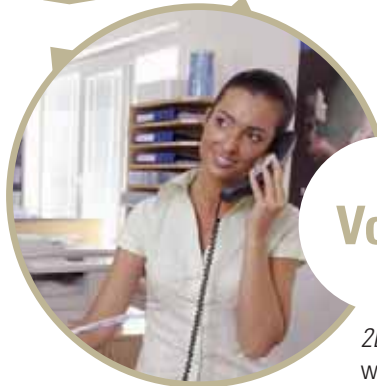

## VoIP

*2ENTRY* Helios can be connected to any PBX with a VoIP interface. You can pick up calls from this door system on an existing desk or IP telephone in the office or at home.

## Who is the *2ENTRY* Helios door system intended for?

- ★ Telecommunication companies
- ★ Electrical fitting companies
- ★ Development companies
- ★ Construction companies
- ★ Architects, designers
- ★ Hotel chains
- ★ Family houses, apartments, blocks of flats
- ★ Hospitals
- ★ Business centres
- ★ Government offices

## Reception

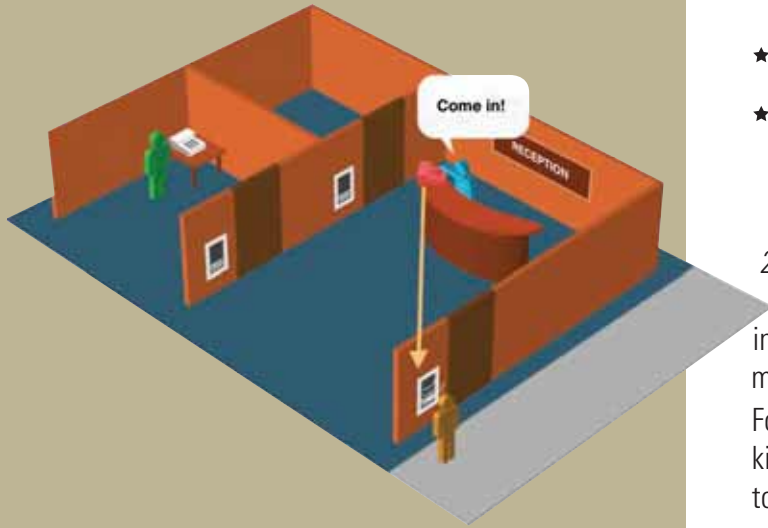

- ★ **The receptionist lets the visitor into the entry hall or waiting room.**
- ★ **He/she directs the visitor to the correct door.**
- ★ **Visitors in the waiting room will be asked to enter via *2ENTRY Helios* directly from the office or consultation room.**

*2ENTRY Helios* represents a standard tool for controlling entrance to a building. In the case of multifunctional buildings, hotels, public buildings and similar access can be remotely managed via a telephone from reception.

For medical facilities *2ENTRY Helios* offers the function of picking up a call where the doctor or nurse can use their telephone to ask a visitor in the waiting room to enter and can then remotely open the door for them.

## Easy opening without keys



- ★ **The numerical keypad also works as the code lock.**
- ★ **Quick opening of door for authorised users**
- ★ **10 codes (max. 16 characters)**
- ★ **Numerical designation of keys**

For commercial buildings, public buildings and entrances of individual departments *2ENTRY Helios* with a code lock represents a suitable solution. The variability of the codes makes it possible to combine various codes for the individual doors or for groups of users. They then have the possibility for opening several doors using the same code.

## Communication over IP protocol



- ★ **Communication occurs via LAN network**
- ★ **Zero costs for calls**
- ★ **Transfer of voice and video directly to PC or laptop**

Communication for entry doors over IP protocol is performed in a modern accessible manner. Over the IP protocol it is possible not only to communicate with the person standing before the entry door, but it is also possible to see him/her and let him/her in. No telephone is necessary, all you need is a PC or laptop.

# *2ENTRY Helios*

## Basic modules



**9135130E**  
3 buttons



**9135160E**  
6 buttons



**9135130KE**  
3 buttons  
and keypad



**9135160KE**  
6 buttons  
and keypad

100 x 210 x 29 mm

## Extender modules



**9135181E**  
Extender 8 buttons



**9135182E**  
Extender 16 buttons



**9135310E**  
Infopanel  
without buttons

100 x 210 x 29 mm

## Roofs, boxes



**9135331E**  
Roof for 1 module  
103 x 218 x 60 mm



**9135332E**  
Roof for 2 modules  
203 x 218 x 60 mm

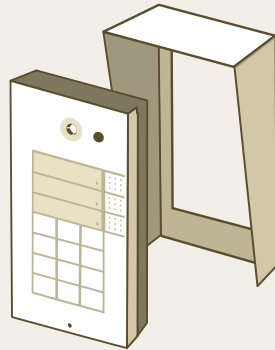

**9135351E**  
Flush fixed box  
for 1 module  
125 x 235 x 46 mm  
Hole:  
110 x 220 x 50 mm



**9135352E**  
Flush fixed box  
for 2 modules  
225 x 235 x 46 mm  
Hole:  
210 x 220 x 50 mm

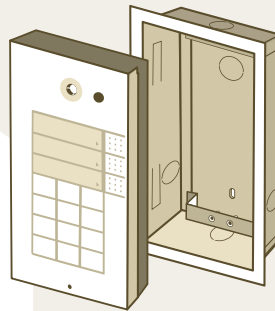

**9135361E**  
Roof & box for masonry  
fitting - 1 module  
129 x 240 x 41 mm  
Hole:  
110 x 220 x 50 mm



**9135362E**  
Roof & box for masonry  
fitting - 2 modules  
229 x 240 x 41 mm  
Hole:  
210 x 220 x 50 mm

## Anti-vandal masks, boxes



**9135511E**  
Anti-vandal mask  
and box for masonry  
fitting  
Mask:  
138,5 x 241 mm  
Hole:  
110 x 220 x 50 mm



**9135511KE**  
Anti-vandal mask  
with keypad and box  
for masonry fitting  
Mask:  
138,5 x 241 mm  
Hole:  
110 x 220 x 50 mm



**9135515E**  
Anti-vandal mask  
for extender and box  
for masonry fitting  
Mask:  
138,5 x 241 mm  
Hole:  
110 x 220 x 50 mm

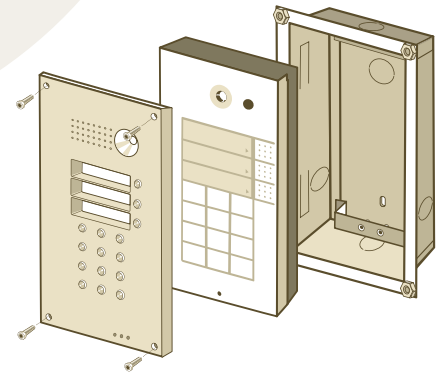

## Additional modules



**9135210E**  
Video camera



**9135250E**  
Additional switch



**9135240E**  
Display

## Accessories



**9134145E**  
Video server  
MPEG4/LAN



**91341711E**  
ATA - Analogue/VoIP  
adapter



**91341481E**  
12V/2A stabilised  
power supply

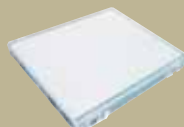

**9135311E**  
Infopanel name plate



**9135302E**  
Doublebutton name  
plate



**9135301E**  
Name plate

# 2ENTRY Helios modular system

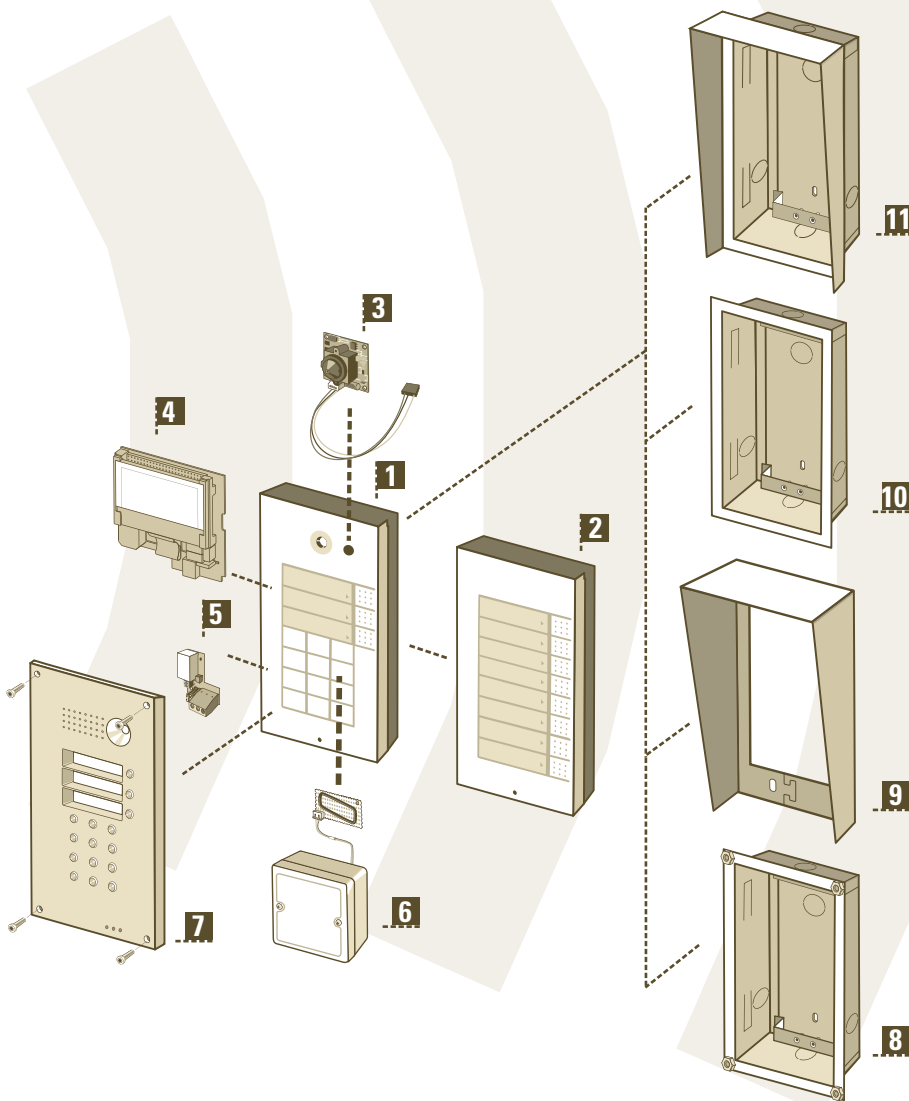

## 1. Basic module

3 buttons  
6 buttons  
3 buttons and keypad  
6 buttons and keypad

## 2. Extender

8 buttons  
16 buttons  
inpanel without buttons

## 3. Video camera

## 4. Display

## 5. Additional switch

## 6. Card reader

## 7., 8. Anti-vandal mask, Box for masonry fitting

for basic module

for basic module and keypad

for extender

## 9. Roofs

for 1 module

for 2 modules

## 10. Flush fixed box

for 1 module

for 2 modules

## 11. Roof and box for masonry fitting

for 1 module

for 2 modules

## Technical parameters

### 2ENTRY Helios

<b>Number of buttons</b>	3-54	<b>Cover</b>	External environment with sufficient rain protection
<b>Connection with PBX</b>	FXS – (internal) analogue telephone line according to standards CCITT	<b>Operational temperature range</b>	-20 - +60 °C
<b>Power supply</b>	From telephone line	<b>Switch – max. voltage/current</b>	max. 48 V/1 A AC
<b>DC voltage drop</b>	< 8 V (I=25 mA)	<b>Dimensions (1 module)</b>	210 x 100 x 29 mm (H x W x D)
<b>(off-hook)</b>	< 16 V (I=50 mA)	<b>Weight</b>	max. 500 g
<b>Dialling</b>	impulse/tone	<b>Coverage</b>	IP 53
<b>Backlight – rated voltage</b>	12 V		



2N TELEKOMUNIKACE a.s., Modřanská 621, 143 01 Praha 4, Czech Republic

Tel.: +420 261 301 500, Fax: +420 261 301 599

E-mail: sales@2n.cz, Web: www.2n.cz